

Inquiry  Order

Customer number: \_\_\_\_\_

Company stamp / address:

Contact person: \_\_\_\_\_

Telephone: \_\_\_\_\_

Quotation No.: \_\_\_\_\_

Commission: \_\_\_\_\_

Type of timber and finish: \_\_\_\_\_

Number of systems: \_\_\_\_\_

Opening direction:  inwards folding  outwards folding (Note: Use interior view!)

Number of panel: \_\_\_\_\_ to the left \_\_\_\_\_ to the right (Please draw a floor plan or a view sketch for better understanding)

Dimensions: Width: \_\_\_\_\_ (Total unfolding) Height: \_\_\_\_\_ (incl. possible floor recession)

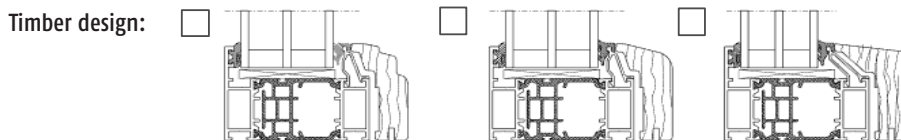

Colour:  RAL 7016  RAL 9006  RAL 9007  RAL 9016  E6-EV1  Special colour \_\_\_\_\_  
 Pre anodizing

Colour of hinges:  E6-EV1 powder  RAL 9011 mat  RAL 9016  Special colour \_\_\_\_\_

Handle colour:  E6-EV1 powder  RAL 9011 mat  RAL 9016  Special colour \_\_\_\_\_

Handle height: H = \_\_\_\_\_  (Indicate handle height from lower panel edge)

Glazing:  Standard heat protection glass 2 x 4/20 SZR Ug 1.1  
 without glass: prepared for \_\_\_\_\_ mm  
 Special glass: \_\_\_\_\_ (Please indicate exact designation)

Floor connection:  with weathered bottom track

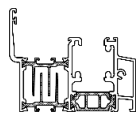

with flush bottom track (height incl. floor recession)



with recessed bottom track and lowerable bottom door seal (height including recess)

Locking of turn panel:  Standard (shoot bolt lock operated from inside only)  
 Shoot bolt lock with PZ (operated from both sides)  
 Roller latch + 2 x dead lock + HEWI push handle  
 Anti-draft lock with mushroom head and 4 point locking, latch and profile cylinder (operable on both sides)  
 Pull handle for turn panel, outward folding system  
 other: \_\_\_\_\_

Additional safety:  Twin-Lock  
 RC2-Safety package

Please enclose floor plan resp. view sketch and remarks (please use inside view)